

# KLAST

[www.klasthome.com](http://www.klasthome.com)

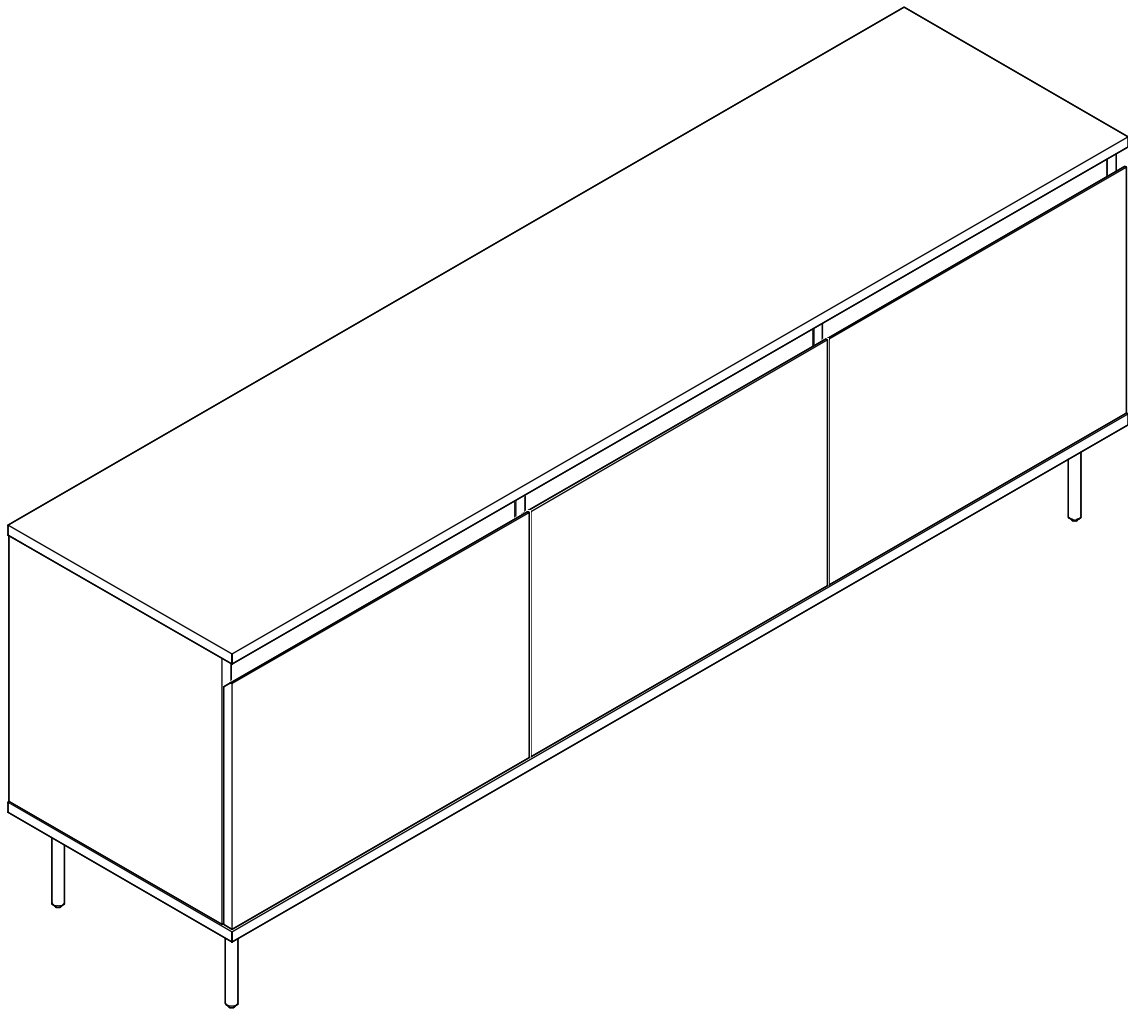

## ESBEN

Ref: SB-0104

1/10

-V2.0-

# KLAST

www.klathome.com

## MATERIAL

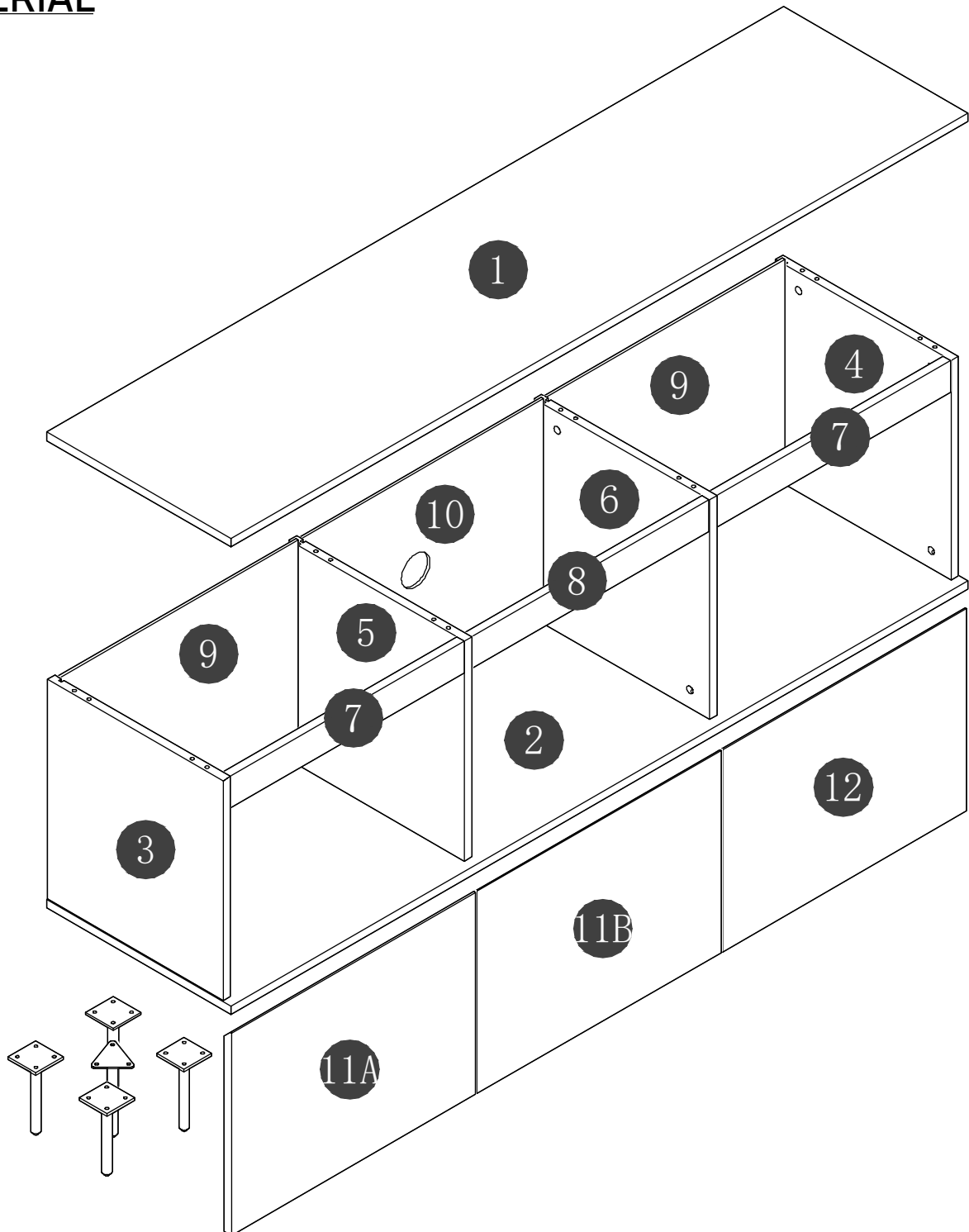

## ESBEN

Ref: SB-0104

2/10

-V2.0-

# KLAST

www.klathome.com

## MATERIAL

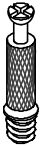

M6x40 mm  
A x17 PC



Ø8x30 mm  
B x22 PC



Ø15x12 mm  
C x17 PC



Ø21 mm  
D x25 PC



E x12 PC

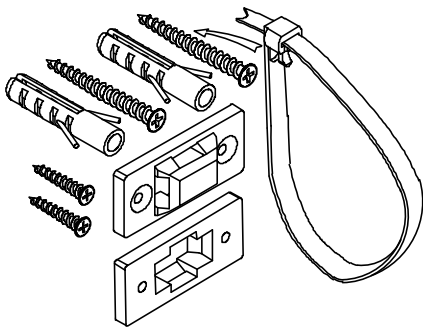

F x1 PC



M6x16 mm  
G x19 PC

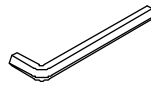

M4  
H x1 PC

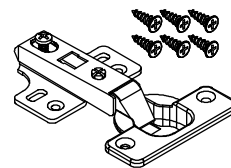

I1 x4 PC

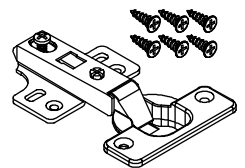

I2 x2 PC

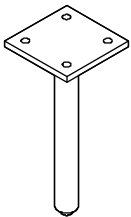

60x60x140 mm  
J-1 x4 PC

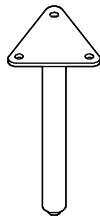

53x53x137 mm  
J-2 x1 PC

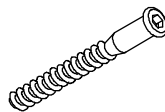

Ø7x50 mm  
Q x8 PC



M4  
Z1 x19 PC



M4  
Z2 x19 PC

## ESBEN

Ref: SB-0104

# KLAST

www.klasthome.com

## STEP 1

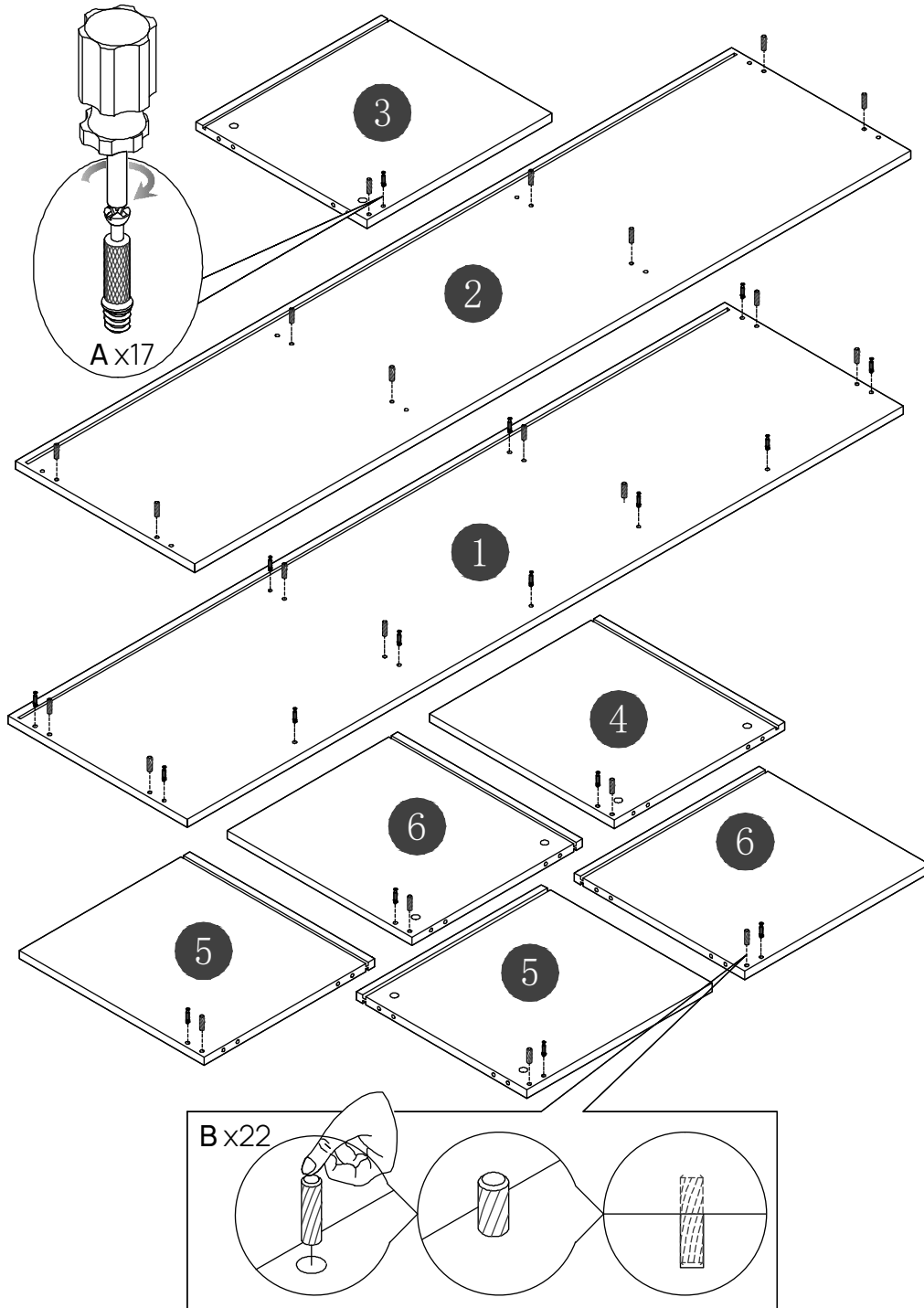

## ESBEN

Ref: SB-0104

# KLAST

www.klasthome.com

## STEP 2

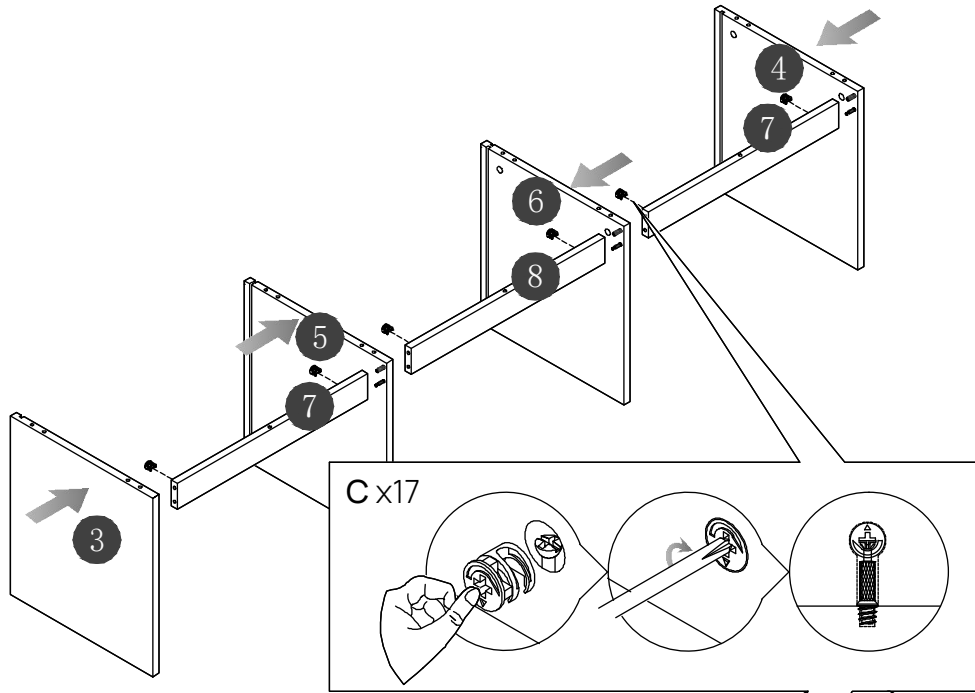

## STEP 3

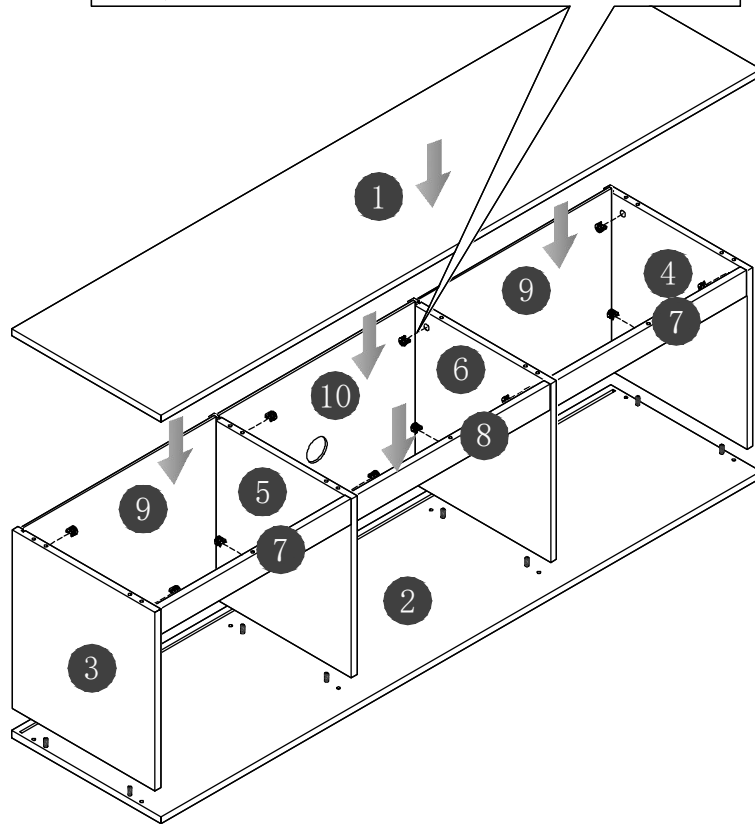

# ESBEN

Ref: SB-0104

# KLAST

www.klathome.com

## STEP 4

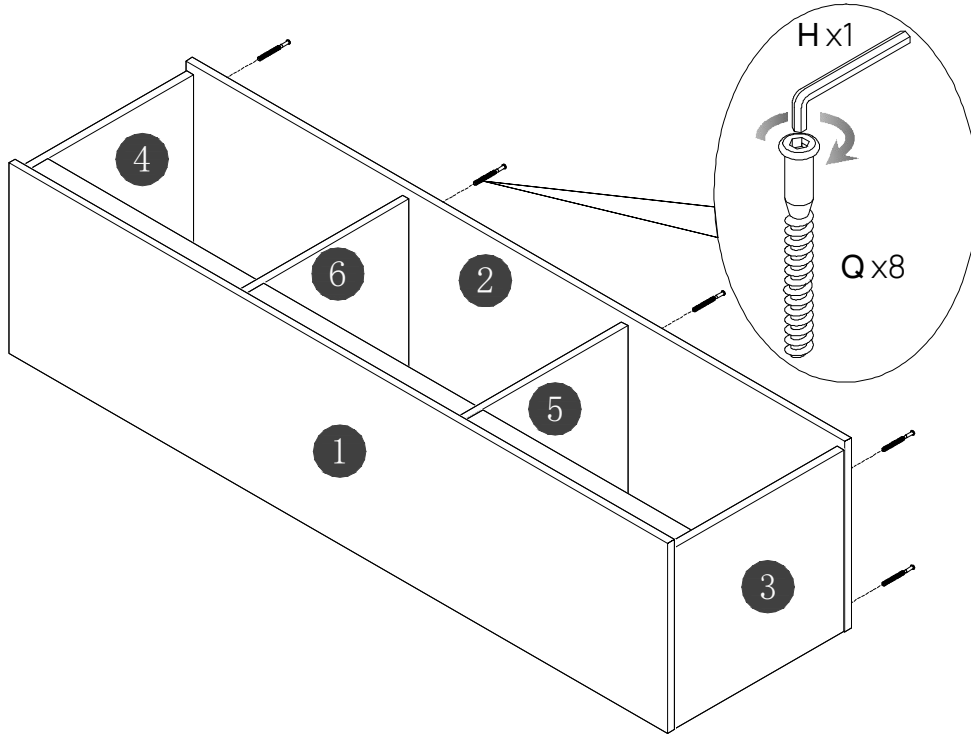

## STEP 5

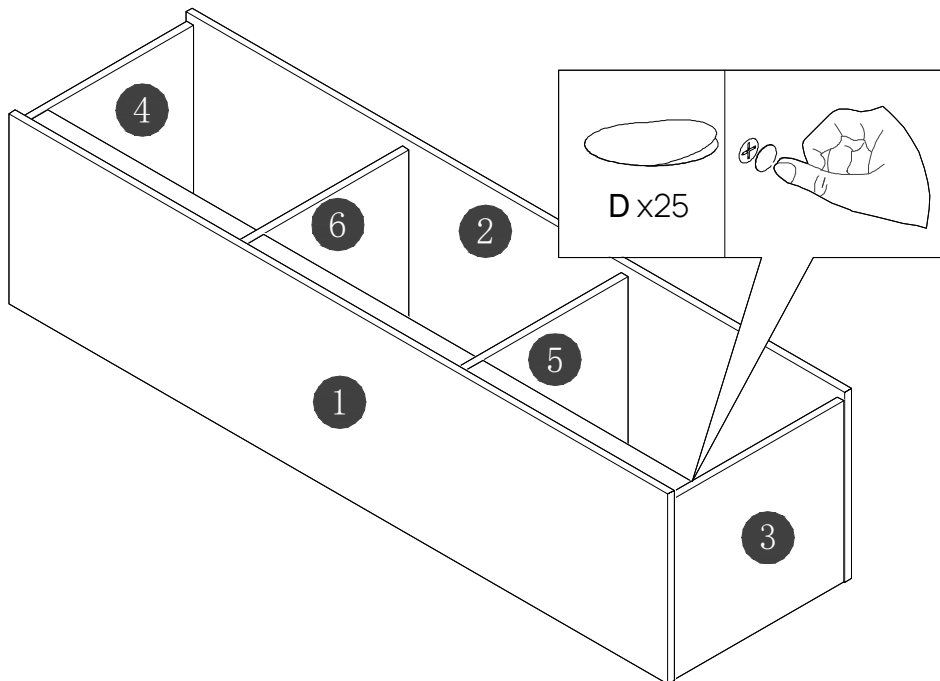

# ESBEN

Ref: SB-0104

6/10

-V2.0-

# KLAST

www.klathome.com

## STEP 6

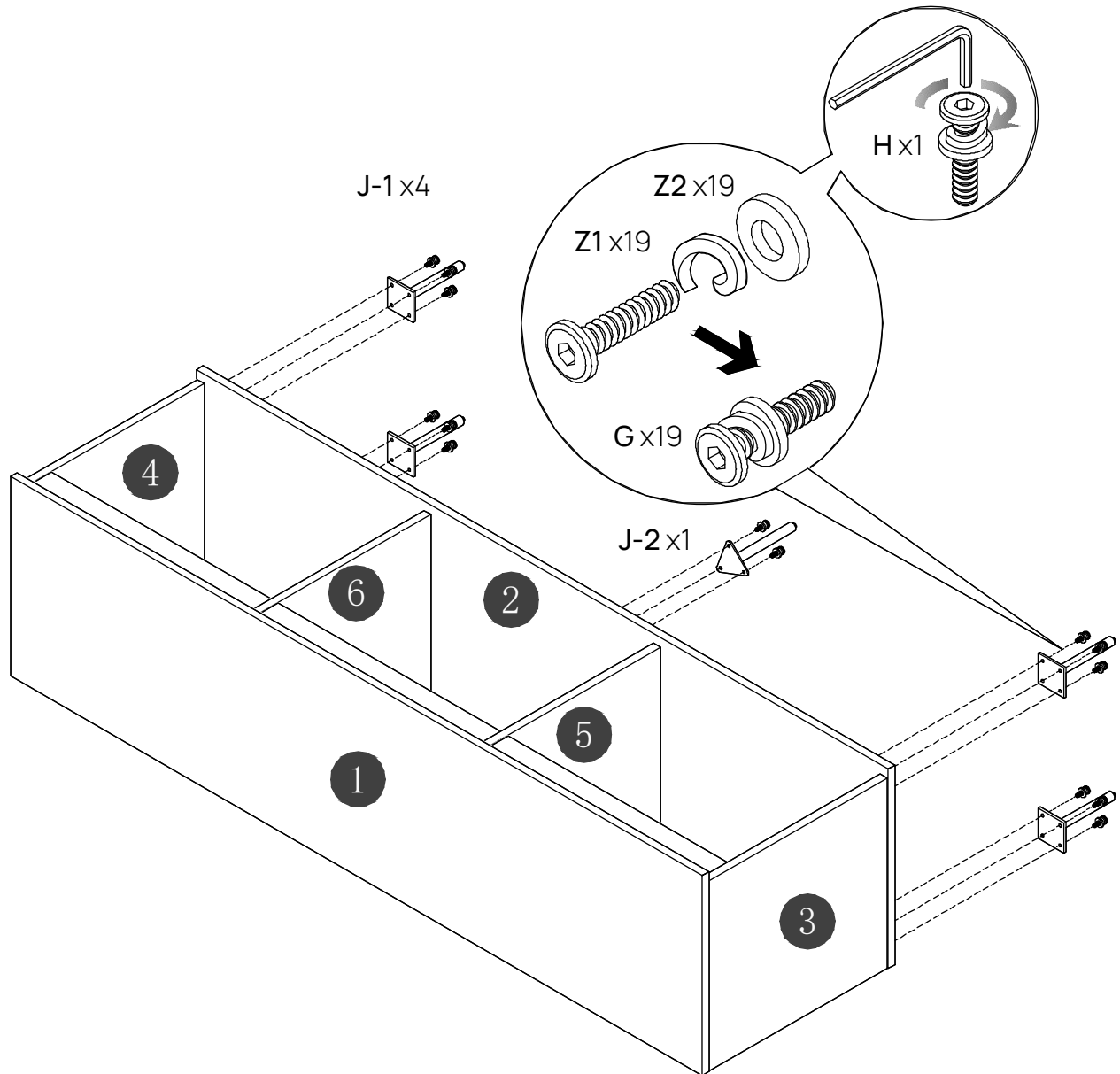

## ESBEN

Ref: SB-0104

7/10

-V2.0-

# KLAST

www.klathome.com

## STEP 7

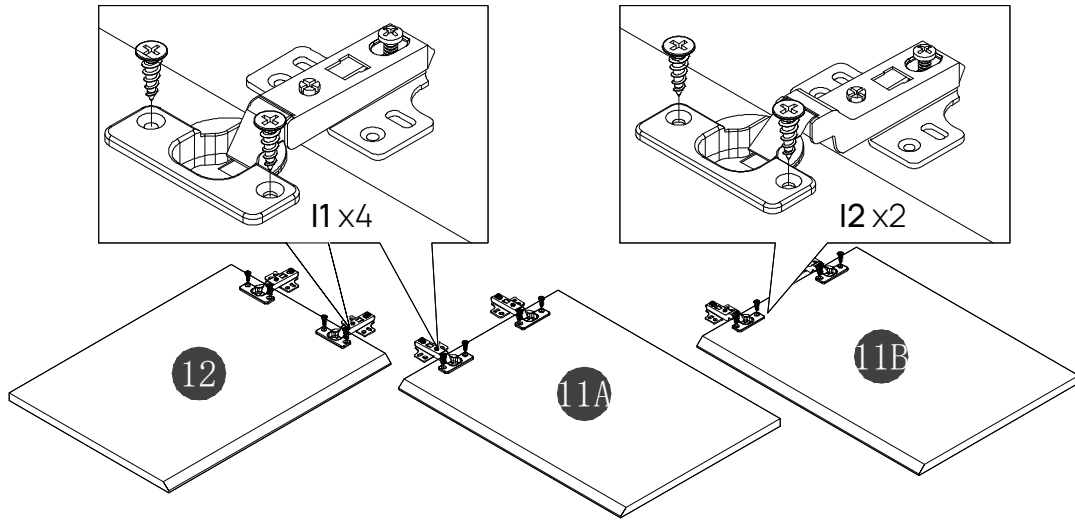

## STEP 8

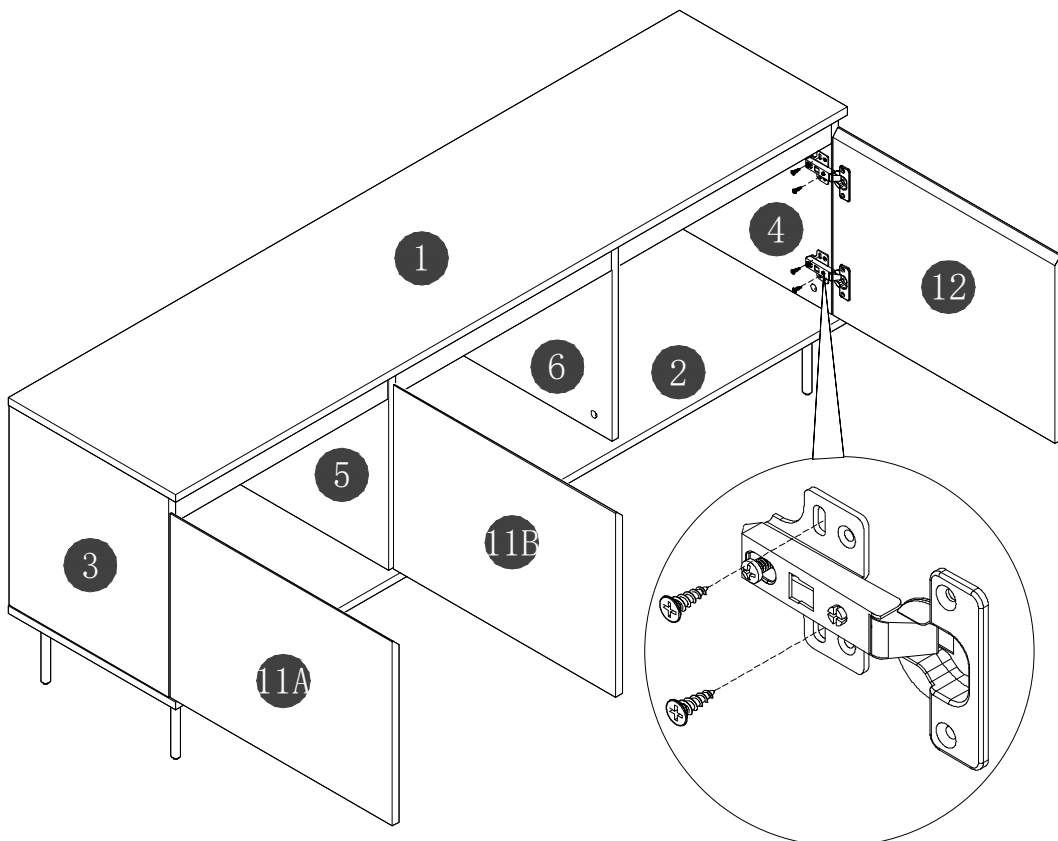

# ESBEN

Ref: SB-0104



# KLAST

www.klathome.com

## STEP 9

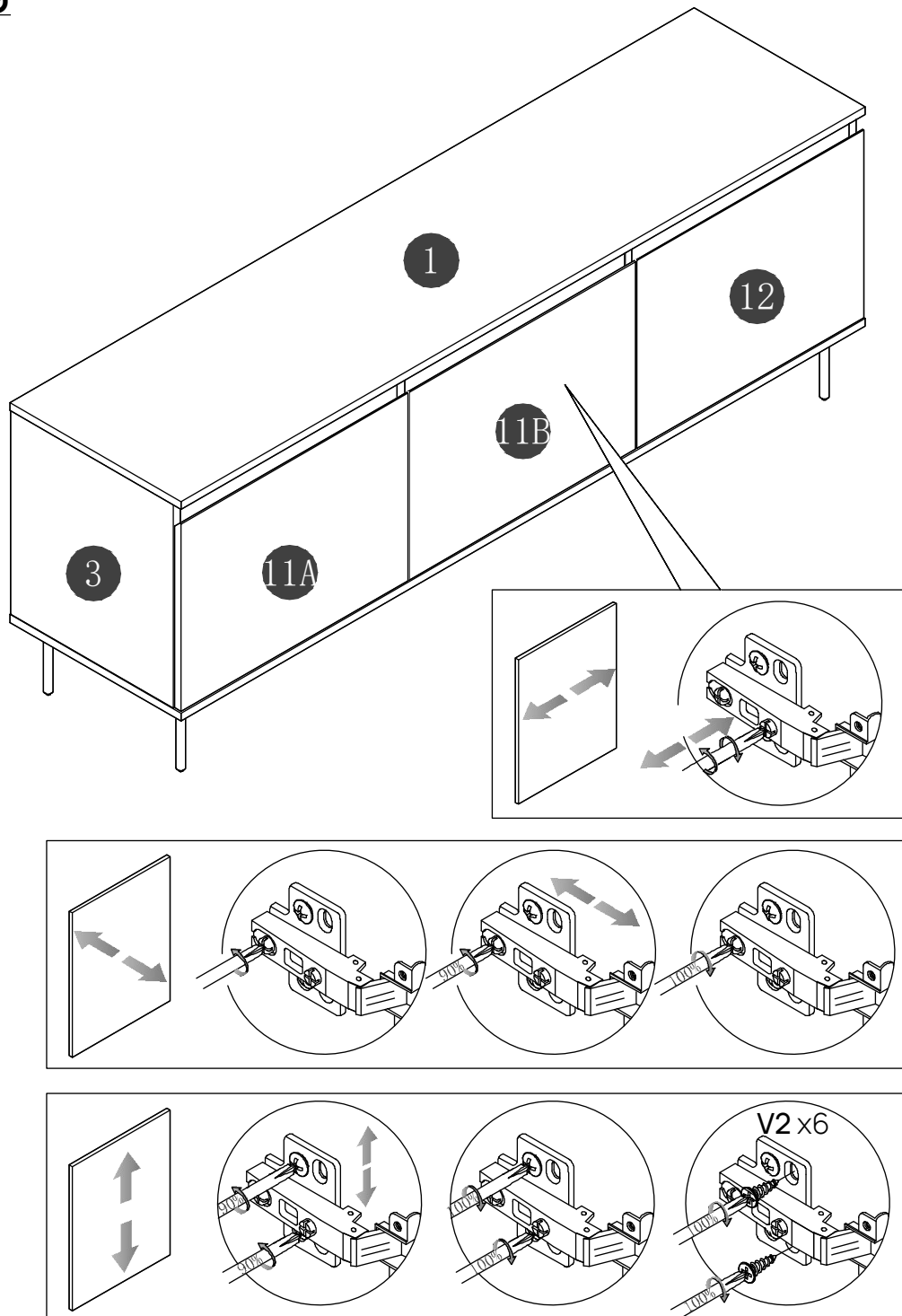

# ESBEN

Ref: SB-0104

# KLAST

www.klasthome.com

## STEP 10

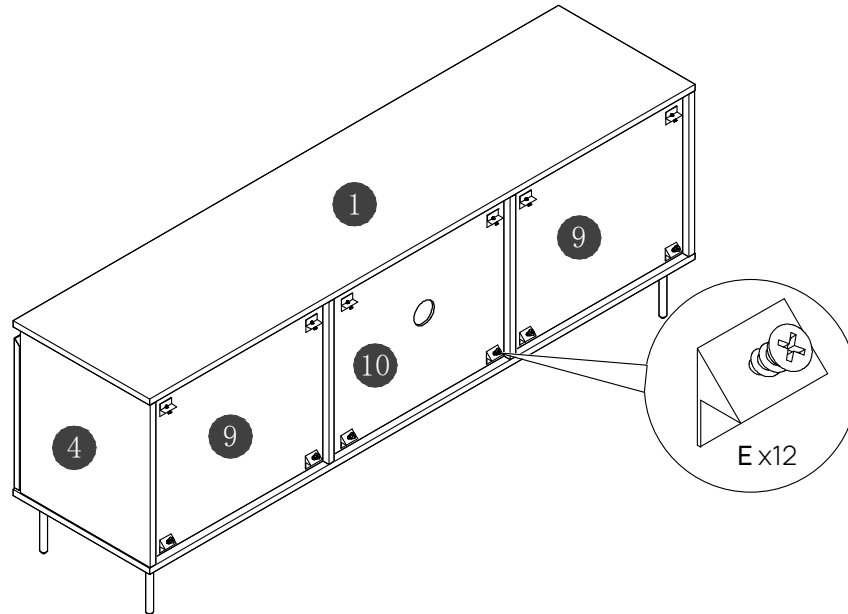

## STEP 11

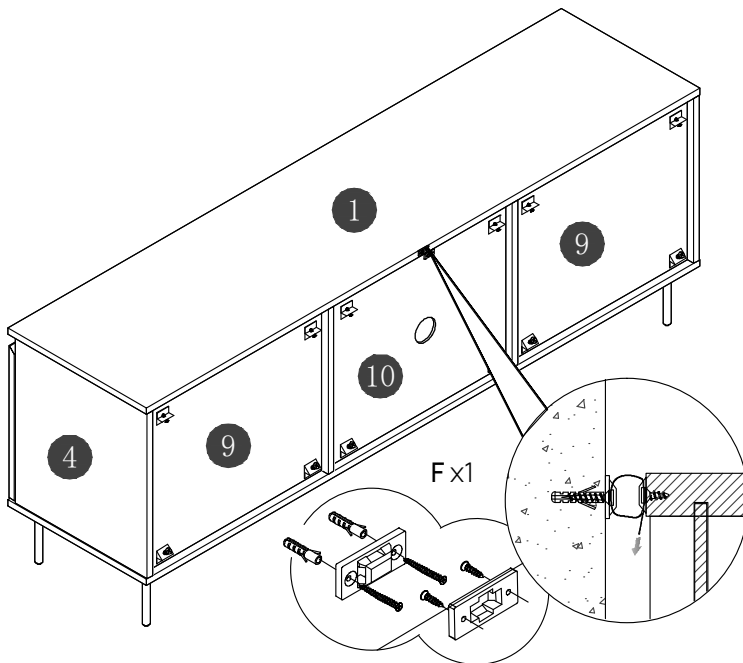

**!** OBLIGATORY FIX ON THE WALL

The needed hardware for the junction wall/furniture depends of the nature of the wall and is not provide.

# ESBEN

Ref: SB-0104

10/10

-V2.0-